

2 SPEED AUGER DRIVES



EXCAVATOR 10T-20T

2-SPEED AUGER DRIVES

| Model | PDT18 | PDT22 | PDT25 |
|----------------------------------|-------------------|-------------|----------------|
| Rec Flow | 40-180 lpm | 40-180 lpm | 40-180 lpm |
| Max Torque (Nm) @ 240 bar | 18,344 | 22,606 | 27,373 |
| Pressure Release Valve | Included | Included | Included |
| Energy Control Valve | Optional | Optional | Optional |
| Max Pressure - Do not exceed | 240 Bar @ 150 lpm | | |
| Max Flow - Do not exceed | 180 lpm @ 200 Bar | | |
| Power - Do not exceed | 60 Kw (80 hp) | | |
| Overall Length (mm) | 979 | 979 | 1217 |
| Diameter (mm) | 340 | 340 | 355 |
| Weight (kg) - No linkage & hitch | 189 | 190 | 400 |
| STD Output Shaft | 75mm Square | 75mm Square | 100mm Square |
| Swing Control (SCS) | Optional | Optional | Optional |
| Diggalign (Auger Alignment) | Optional | Optional | Optional |
| Recommended Auger Diameter | | | |
| Recommended Auger | A8/RC8/DR8 | A8/RC8/DR8 | RC10/RC11/DR11 |
| Max Auger Dia Fracturable Rock* | 1500mm | 1500mm | 1500mm |
| Max Auger Dia Clay/Shale* | 1500mm | 1500mm | 1500mm |
| Max Auger Dia Earth* | 1600mm | 1600mm | 1600mm |

**FOR BETTER DRILLING ACCURACY
ADD DIGGALIGN** (Sold Separately)



AUGERS TO SUIT (Sold Separately)

- TRU-CUT – a 300mm auger cuts a 300mm hole. No more oversized holes!
- Over 30 years of auger design and manufacture has resulted in an extremely efficient cutting head design and optimum flight pitches to provide maximum soil removal in all ground conditions.
- Easy knock in and out teeth requires no special tools.



ESSENTIALLY 2 DRIVE UNITS IN ONE

Save time and money by eliminating the need for multiple drive units.

LOW SPEED - HIGH TORQUE

Ideal for drilling with large diameter augers / hard fracturable rock.

HIGH SPEED - LOW TORQUE

Ideal for small diameter augers or softer soils where speed is needed.

Switch to high speed for added spin off speed for clearing larger diameter augers.

FEATURES

- Compact high torque Digga gearbox
- Fitted with high efficiency Eaton VIS motor
- Integrated PRV (Pressure Relief Valve)
- Extreme duty shaft locking system
- Low maintenance with 5 year gear box and 3 year motor warranty



GENERAL PURPOSE AUGER

- Dig holes in earth conditions and clay
- Earth and Tungsten Teeth Available

COMBINATION ROCK & EARTH AUGER

- Dig holes in earth conditions, clay, asphalt, concrete and fracturable rock
- All purpose cutting heads - no more interchanging cutting heads & using multiple augers

DEDICATED ROCK AUGER

- Rotating rock picks for shale and fracturable rock
- Heavy duty efficient cutting head for the ultimate rock drilling auger

Output speed and torque specifications are THEORETICAL. Speed and torque output are dependent on the overall system efficiencies associated with the prime movers hydraulic system. This document should be used for information and comparative purposes only. When determining criteria, & application-specific information is required, please contact DIGGA. (*) Max/min drilling diameter (DIA) dependant on ground conditions. Guide is a recommendation only.

2 SPEED AUGER DRIVES



EXCAVATOR 10T-20T

OUTPUT SPEED

| Model | PDT18 | | PDT22 | | PDT25 | |
|-------|------------------------|--------------------------|------------------------|--------------------------|------------------------|--------------------------|
| | Hi Torque Low Speed | Low Torque High Speed | Hi Torque Low Speed | Low Torque High Speed | Hi Torque Low Speed | Low Torque High Speed |
| 40 | 8 | 13 | 7 | 10 | 6 | 8 |
| 50 | 10 | 16 | 8 | 13 | 7 | 11 |
| 60 | 13 | 19 | 10 | 15 | 8 | 13 |
| 70 | 15 | 22 | 12 | 18 | 10 | 15 |
| 80 | 17 | 25 | 14 | 20 | 11 | 17 |
| 90 | 19 | 28 | 15 | 23 | 13 | 19 |
| 100 | 21 | 32 | 17 | 26 | 14 | 21 |
| 110 | 23 | 35 | 19 | 28 | 15 | 23 |
| 120 | 25 | 38 | 20 | 31 | 17 | 25 |
| 130 | 27 | 41 | 22 | 33 | 18 | 27 |
| 140 | 29 | 44 | 24 | 36 | 20 | 30 |
| 150 | 31 | 47 | 25 | 38 | 21 | 32 |
| 160 | 33 | 51 | 27 | 41 | 22 | 34 |
| 170 | 35 | 54 | 29 | 44 | 24 | 36 |
| 180 | 38 | 57 | 30 | 46 | 25 | 38 |

OUTPUT TORQUE

| Model | PDT18 | | PDT22 | | PDT25 | |
|-------|-----------------|------------------|-----------------|------------------|-----------------|------------------|
| | Hi Torque Nm | Low Torque Nm | Hi Torque Nm | Low Torque Nm | Hi Torque Nm | Low Torque Nm |
| 90 | 6,879 | 4,540 | 8,477 | 5,595 | 10,265 | 6,775 |
| 100 | 7,643 | 5,045 | 9,419 | 6,217 | 11,405 | 7,528 |
| 110 | 8,408 | 5,549 | 10,361 | 6,838 | 12,546 | 8,280 |
| 120 | 9,172 | 6,053 | 11,303 | 7,460 | 13,687 | 9,033 |
| 130 | 9,936 | 6,558 | 12,245 | 8,082 | 14,827 | 9,786 |
| 140 | 10,701 | 7,062 | 13,187 | 8,703 | 15,968 | 10,539 |
| 150 | 11,465 | 7,567 | 14,129 | 9,325 | 17,108 | 11,291 |
| 160 | 12,229 | 8,071 | 15,070 | 9,946 | 18,249 | 12,044 |
| 170 | 12,994 | 8,576 | 16,012 | 10,568 | 19,389 | 12,797 |
| 180 | 13,758 | 9,080 | 16,954 | 11,190 | 20,530 | 13,550 |
| 190 | 14,522 | 9,585 | 17,896 | 11,811 | 21,670 | 14,302 |
| 200 | 15,287 | 10,089 | 18,838 | 12,433 | 22,811 | 15,055 |
| 210 | 16,051 | 10,594 | 19,780 | 13,055 | 23,951 | 15,808 |
| 220 | 16,815 | 11,098 | 20,722 | 13,676 | 25,092 | 16,561 |
| 230 | 17,580 | 11,603 | 21,664 | 14,298 | 26,233 | 17,313 |
| 240 | 18,344 | 12,107 | 22,606 | 14,920 | 27,373 | 18,066 |

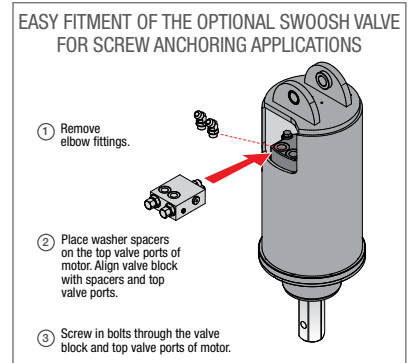

Digga's auger drives can be converted to screw anchor drives in 3 easy steps with the addition of our patented 'Anti Kickback Valve'. The valve controls the rapid decompression of oil which occurs during pile instillation. A pile builds up rotational energy, somewhat like a rubber band on a wind up model plane. The pile momentarily kicks back, forcing energy back up the pile through the drive shaft to the gear box, through the hydraulic motor. This action momentarily causes the motor to effectively turn into a high speed pump, potentially causing costly motor failure. Fitted to the drive manifold, the Anti Kickback Valve controls this release of energy. Digga's 5 year gearbox and 3 year motor warranty does not allow to auger drives which are used for screw anchoring and not fitted with an Anti Kickback Valve.

Output speed and torque specifications are THEORETICAL. Speed and torque output are dependent on the overall system efficiencies associated with the prime movers hydraulic system. This document should be used for information and comparative purposes only. When determining criteria, & application-specific information is required, please contact DIGGA. (*) Max/min drilling diameter (DIA) dependant on ground conditions. Guide is a recommendation only.